

Counter Top Installation Instructions of C-640 Ionized Microcluster Alkaline Water Purification System

See the reverse side for under sink instruction

This setup is mobile, ideal for rental apartment, recreational vehicle or boat.

1. Take out the diverter valve, the thread adapter and the rubber adapter.

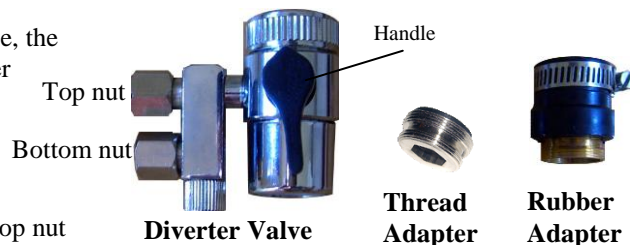

2. Unscrew and release the top nut and bottom nut from the diverter valve, and insert one hose through one of the nuts.



3. Push the hose into the diverter valve. Then screw the nut back to the diverter valve.

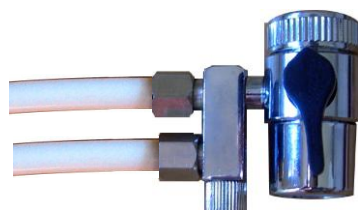

4. Repeat step 2 and 3 to connect the other hose to the diverter valve through the other nut.

5. Make sure to use a wrench to firmly screw both the top and the bottom nuts into the diverter valve to avoid water leakage.

6. Take out the water purification system. Its inlet is marked as "IN", and its outlet is marked as "OUT".



7. Unscrew the two stoppers from its inlet and outlet.

8. Place a washer (black rubber O-ring) into its inlet and outlet, and then screw a connector into its inlet and outlet.



9. Take the hose connected to the **top** nut of the diverter valve, and push it firmly into the **inlet** of the purification system. Take the hose connected to the **bottom** nut of the diverter valve, and push it firmly into the **outlet** of the purification system, so that water flows as indicated below:

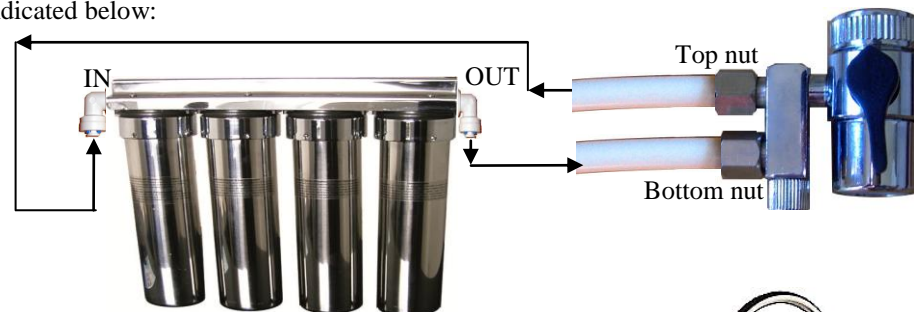

If you ever need to disconnect the hoses, take off the blue clip from the plug of the connector, push the plug into the connector, and then pull out the hose.

10. Unscrew and release the head from your original tap faucet.

11. Connect the diverter valve to the tap faucet. You may need to use the **thread adapter** if your faucet is female instead of male. Make sure to use the **washer** (rubber O-ring) to prevent leaking. There is also a **rubber adapter** which can be used on non-standard faucets. The diameter of the rubber adapter can be increased by taking out the inner rubber.

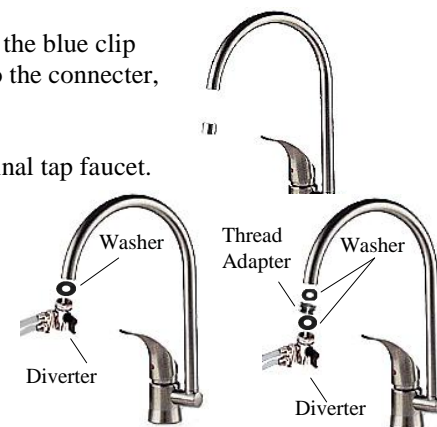

12. Use the small handle on the diverter valve to switch between tap water and ionized microcluster alkaline water.

13. Now you can use the test kit to test water pH and chlorine level.

14. After installation, the water may have a taste of new machine, **leave the ionized microcluster alkaline water running for 2 minutes** before drinking during the first week. Do not run hot water into this machine. After shutting off the valve, water left inside the machine will keep flowing out until it's empty. This is normal and because the valve shuts off inlet. Undersink setup shuts off outlet and does not have this issue.

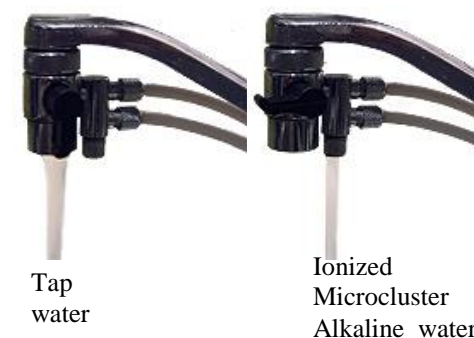

Under Sink Installation Instructions of C-640 Ionized Microcluster Alkaline Water Purification System

This setup is permanent and ideal for owner's house or condo, and it must be installed by a certified and insured plumber. Water80 and Water80's distributors are not responsible for any damage if it's not installed by a certified and insured plumber. The fittings in red are not included. You can take a picture of your tap water outlet and get the fittings from HomeDepot or plumbing shop.

WITH a separate drinking water faucet

Filter Replacement:

Each stainless steel cylinder is full of water. Put the purification system inside the sink or place a bucket and a towel under the stainless steel cylinder to prevent water from spilling.



Open the valve on the drinking water faucet and shut down water main switch until no water flows out of the faucet. To open, use the special screw driver included to turn the cylinder clockwise, and then replace the inner filter inside the cylinder.

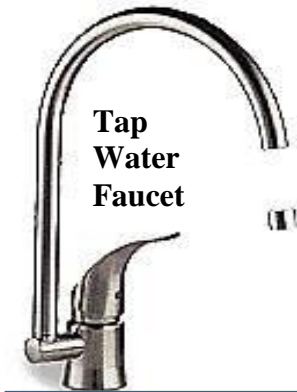

Tap Water Faucet

Warning:
The plumber must measure tap water pressure prior to installation. If the pressure is higher than 80 psi, install a pressure reducer before the system to bring it down to 50 psi. After installation, use a dry paper towel to wipe each joint and cylinder to make sure the paper does not get wet so that there is no leaking.

Shut off water inlet if nobody is at home for more than one day.

Counter

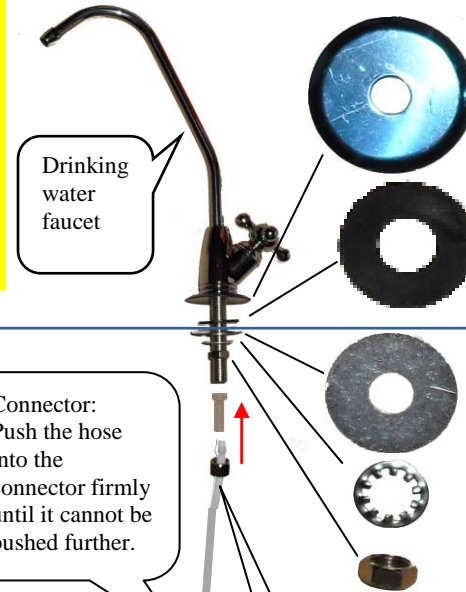

Drinking water faucet

1. Take off the protection nuts from both the inlet and the outlet.
 2. Make sure there is a washer (rubber O-ring) inside both the inlet and the outlet.

Connector: Push the hose into the connector firmly until it cannot be pushed further.

1/2-in to 1/2-in male connector

3/8- in T fitting. Some houses may require different size.

Washer
 1/2-in Inlet: marked as IN on top.

Washer
 1/2-in Outlet: marked as OUT on top.

3/8-in to 1/2-in flexible connector. Some houses may require different size.

Plastic Stick

Insert the hose through the mental nut and the plastic ring. Use a lighter to burn the tip of the hose for 3 seconds, and then insert the plastic stick into the hose. Finally connect the hose to the dinking water faucet by tightening the metal nut.

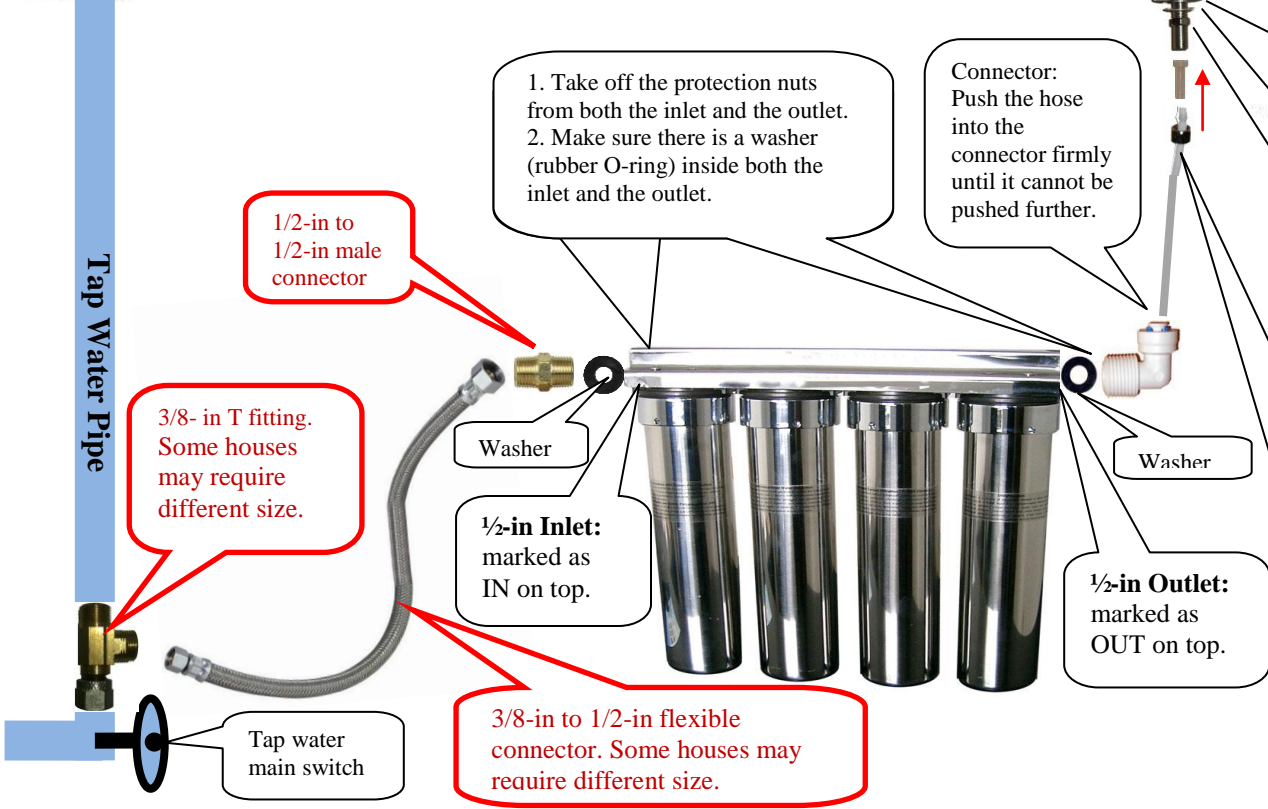

Under Sink Installation Instructions of C-640 Ionized Microcluster Alkaline Water Purification System

This setup is permanent and ideal for owner's house or condo, and it must be installed by a certified and insured plumber. Water80 and Water80's distributors are not responsible for any damage if it's not installed by a certified and insured plumber. The fittings in red are not included. You can take a picture of your tap water outlet and get the fittings from HomeDepot or plumbing shop.

WITHOUT separate drinking water faucet



Warning:

The plumber must measure tap water pressure prior to installation. If the pressure is higher than 80 psi, install a pressure reducer before the system to bring it down to 50 psi. After installation, use a dry paper towel to wipe each joint and cylinder to make sure the paper does not get wet so that there is no leaking.

Shut off water inlet if nobody is at home for more than one day.

For this setup, because both unfiltered hot water and filtered cold water come from the same faucet, every time after you use hot water, turn the faucet valve to cold water and leave the water running for 10 seconds so that you won't drink the unfiltered hot water.

Filter Replacement:

Each stainless steel cylinder is full of water. Put the purification system inside the sink or place a bucket and a towel under the stainless steel cylinder to prevent water from spilling.

Open the valve on the drinking water faucet and shut down main tap water valve until no water comes out of the faucet. To open, use the special screw driver included to turn the cylinder clockwise, and then replace the inner filter inside the cylinder.

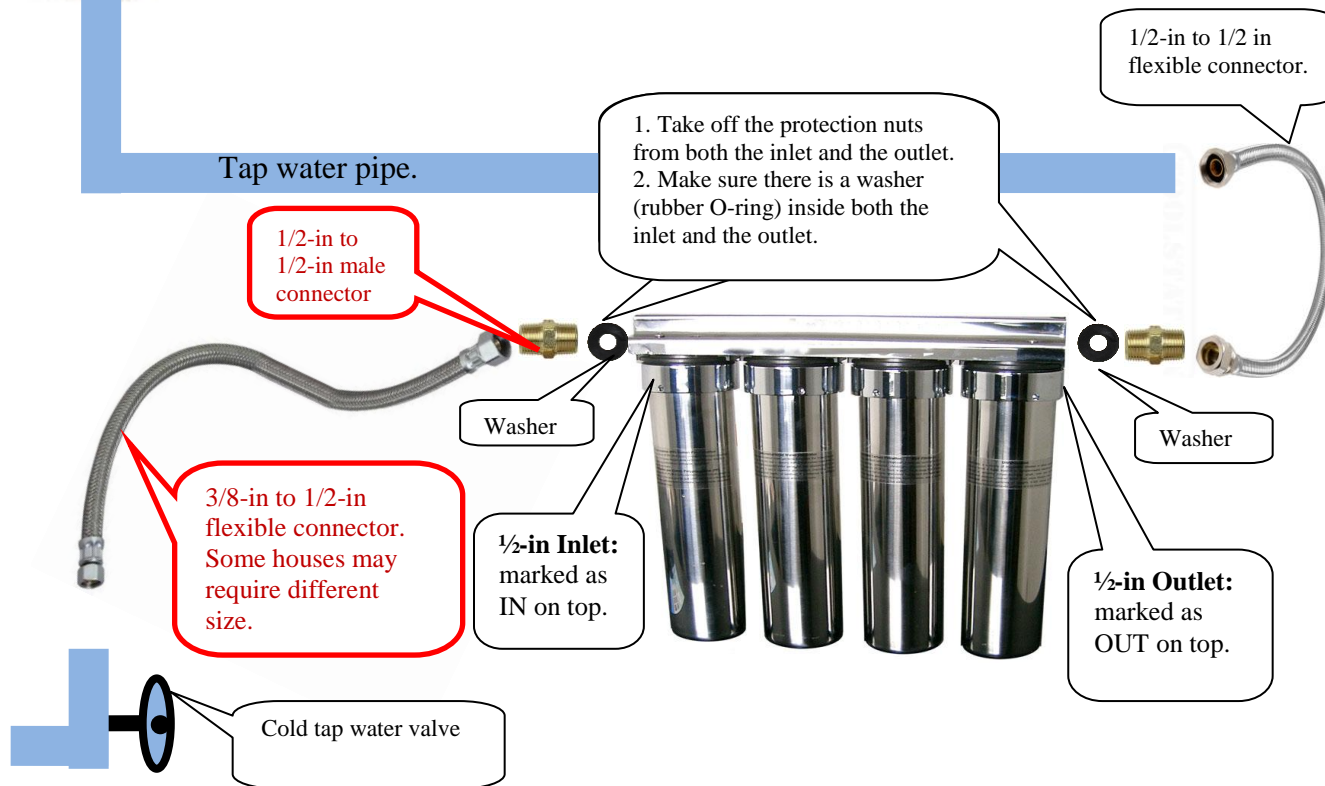

Water80 Ecological Technologies, Ltd.
Vancouver, BC Canada V7X 1M8
www.water80.com
1-866-961-2391